

## SOLVENT WELD SEWER & DRAIN FITTINGS

### Variable Angle Fittings

Patent Pending



Part No.	Description	Color	Pkg. Qty.	Wt. Ea. (lbs.)	Product Class
4PVAF	NDS 4" Swivel Fit®	White	12	1.00	30PV

### Cross



PVC	Part No.	Description	Color	Pkg. Qty.	Wt. Ea. (lbs.)	Product Class
	4P1X	4" PVC Cross (HUB x HUB x HUB x HUB)	White	20	1.40	30PV

### Corrugated Adapter



Part No.	Description	Color	Pkg. Qty.	Wt. Ea. (lbs.)	Product Class
351	3" Polyethylene Corrugated Adapter (CORR HUB x S&D SPT or HUB)	Black	50	0.10	30ST
451	4" Polyethylene Corrugated Adapter (CORR HUB x S&D SPT or HUB)	Black	25	0.20	30ST
651	6" Polyethylene Corrugated Adapter (HUB x S&D SPT)	Black	12	0.25	30ST

### DWV to Sewer and Drain Adapter

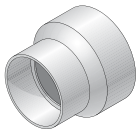

PVC	Part No.	Description	Color	Pkg. Qty.	Wt. Ea. (lbs.)	Product Class
	3P12	3" x 4" PVC DWV to Sewer and Drain Adapter (DWV HUB x S&D HUB)	White	50	0.50	30PV
	3P15	3" x 3" PVC DWV to Sewer and Drain Adapter (DWV HUB x S&D HUB)	White	60	0.41	30PV
	3P16	4" x 4" PVC DWV to Sewer and Drain Adapter (DWV HUB x S&D HUB)	White	30	0.80	30PV
	3P17	3" x 4" PVC DWV to Sewer and Drain Adapter (DWV HUB x S&D SPT)	White	30	0.50	30PV

### DWV to Sewer & Drain Adapter Bushing



PVC	Part No.	Description	Color	Pkg. Qty.	Wt. Ea. (lbs.)	Product Class
	2P41	3" PVC DWV to S&D Adapter Bushing (DWV SPT x S&D HUB)	White	50	0.12	30PV
	2P42	4" PVC DWV to S&D Adapter Bushing (DWV SPT x S&D HUB)	White	25	0.24	30PV
	2P43	6" PVC DWV to S&D Adapter Bushing (DWV SPT x S&D HUB)	White	20	0.70	30PV

### Reducer Bushing (SCH. 40 HUB x S&D SPT)



PVC	Part No.	Description	Color	Pkg. Qty.	Wt. Ea. (lbs.)	Product Class
	532	2" x 3" PVC Reducer Bushing (SCH. 40 HUB x S&D SPT)	White	20	0.20	30PV
	533	2" x 4" PVC Reducer Bushing (SCH. 40 HUB x S&D SPT)	White	20	0.35	30PV

### Reducer Bushing (6-inch S&D SPT)



STYRENE	Part No.	Description	Color	Pkg. Qty.	Wt. Ea. (lbs.)	Product Class
	643	6" x 4" x 3" Styrene Reducer Bushing (6" S&D SPT)	Black	20	0.75	30ST